



Advanced Technology. Simple Solutions.

## TIN PLATED BUS BARS

### Features/Specifications

- Tin plated aluminum
- Tin plated copper
- 12 foot (standard)

### Optional cut lengths available

- 2 ft. length add (-2) to part number
- 4 ft. length add (-4) to part number
- 6 ft. length add (-6) to part number
- 8 ft. length add (-8) to part number
- 10 ft. length add (-10) to part number

(Example for a 4 ft. length - p/n: V-ALFBT.25X1-4)

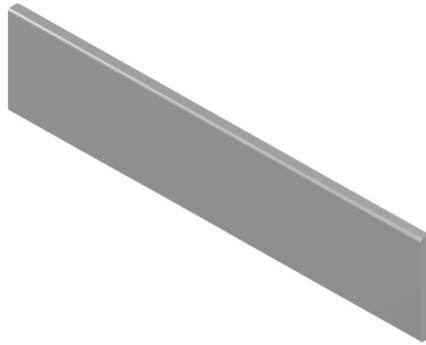

### Tin Plated Aluminum

PART NUMBER	TYPE	THICKNESS	WIDTH	LENGTH
V-ALFBT.25X1	Tin Plated Aluminum	1/4"	1"	144"
V-ALFBT.25X2	Tin Plated Aluminum	1/4"	2"	144"
V-ALFBT.25X3	Tin Plated Aluminum	1/4"	3"	144"
V-ALFBT.25X4	Tin Plated Aluminum	1/4"	4"	144"

### Tin Plated Copper

PART NUMBER	TYPE	THICKNESS	WIDTH	LENGTH
V-CUFBT.25X1	Tin Plated Copper	1/4"	1"	144"
V-CUFBT.25X1.5	Tin Plated Copper	1/4"	1-1/2"	144"
V-CUFBT.25X2	Tin Plated Copper	1/4"	2"	144"
V-CUFBT.25X3	Tin Plated Copper	1/4"	3"	144"
V-CUFBT.25X4	Tin Plated Copper	1/4"	4"	144"

Rev-1.1



Advanced Technology. Simple Solutions.

## EECOL GROUND WELLS

### Features/Specifications

- Galvanized steel construction
- Removable cover
- Ecol logo on lid

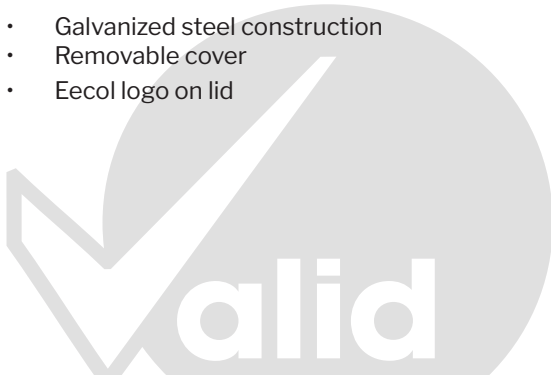

PART NUMBER	HEIGHT	DIAMETER
GWE	12-1/4"	10"



Rev-1.1