



Advanced Technology. Simple Solutions.

GROUND FAULT INDICATOR

GFD

The GFD ground fault indicator enclosure is an all-encompassing device that can be used indoors or outdoors to indicate any presence of current to ground. When no ground fault is present, the three indicator lamps glow with equal brightness. When a ground fault is detected, the lamp associated with the grounded phase turn off, and the remaining lamps brighten.

Features / Specifications

- 6 in. H X 6 in. W X 4 in. D Type 3R galvanized steel enclosure
- 3 transformer indicator lights on front cover
- 3 pilot light lenses
- Provides visual indication of presence of ground path
- Lights wired to terminals for customer connections
- Up to 600V
- Enclosure powder coated PC101 Grey
- Assembly certified to CSA standards

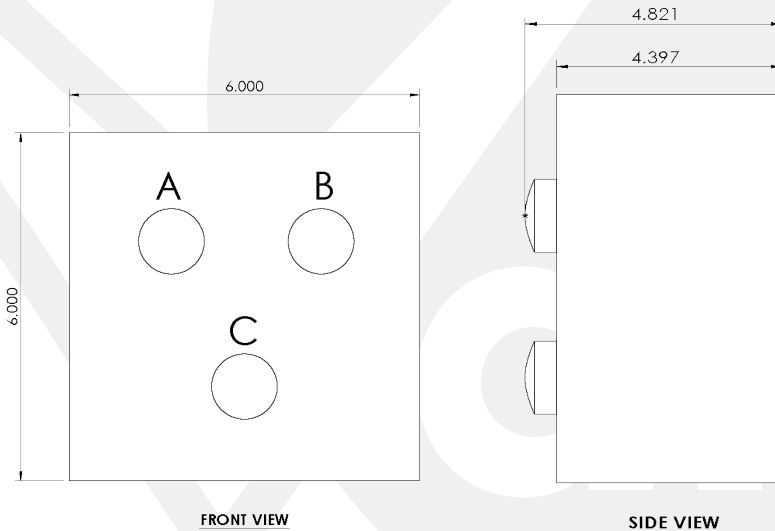

| PART NUMBER | SYSTEM |
|-------------|----------------|
| GFD-5551 | 600VAC 3-PHASE |
| GFD-5441 | 480VAC 3-PHASE |
| GFD-5221 | 240VAC 3-PHASE |