



Advanced Technology. Simple Solutions.

HIGHWAY SERVICE PANEL

HWYSP40

This family of HWYSP40 Highway Service Panel can be used on any steel pole for street lighting or power distribution. It is a specialty service panel that can be fed from a supply authority overhead or underground service. The padlockable swing door enables easy access. A Type 3R rating and stainless steel construction offer additional protection.

Features / Specifications

- 304 stainless steel construction
- Service entrance rated
- CSA Type 3R rated
- Overhead or underground service applications
- Photocell bypass switch
- Lock-out tab on main breaker
- Mounting hardware and conduit fittings included
- 40 cct panel
- 120/240 VAC 1-phase
- 10 kAIC rated
- 200A main breaker
- Padlockable swing door
- 1 1/4-in. conduit entry and 2-in. pole access hole in back
- Contactors and controls section for up to five 4-pole contactors or flashers
- Listed on BC MOT&I recognized products list

Options

- Snowplow debris cover
- Up to 5 lighting contactors
- Flasher controls
- Sub-breakers as required up to 22 kAIC
- Additional contactors
- Crosswalk flasher
- Warning board flasher

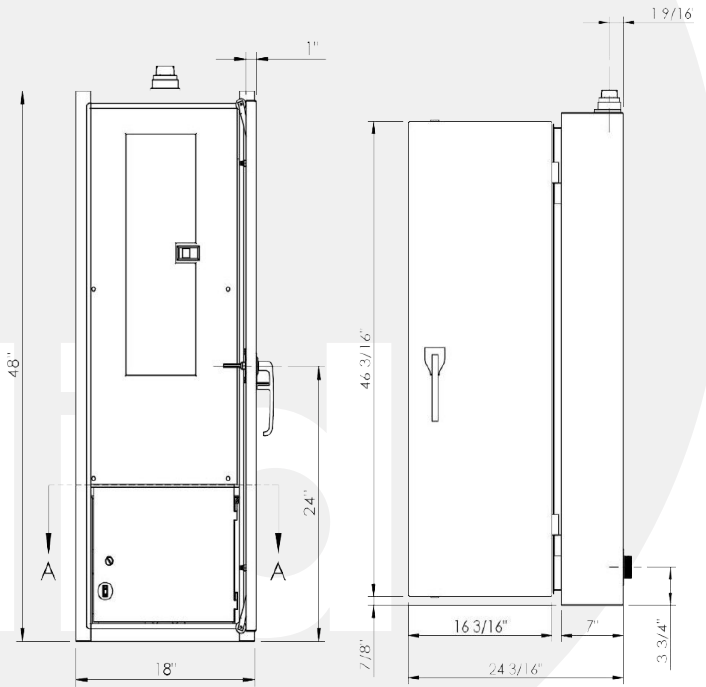
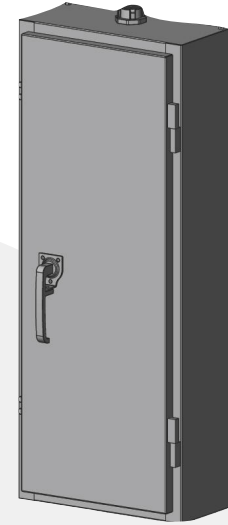

Front View

Side View (Door Open)

PART NUMBER	HEIGHT	WIDTH	DEPTH	MAIN SERVICE	SERVICE	MAX # CONTACTORS
HWYSP40-20S	48 in	18 in	8 in	120/240V 200A 1PH	OVERHEAD	5
HWYSP40-20S-U	48 in	18 in	8 in	120/240V 200A 1PH	UNDERGROUND	5

Contact Valid for all available options.