



Advanced Technology. Simple Solutions.

HIGHWAY SERVICE PANEL

HWYSP8-3S

This HWYSP8 service panel can be used on any steel pole for street lighting or power distribution and is fed from a supply authority overhead service. The padlockable flip-up cover enables easy access. A Type 3R rated stainless steel construction offers additional protection.

Features / Specifications

- 304 stainless steel construction
- Service entrance rated
- CSA Type 3R rated
- Overhead service only
- PEC bypass switch
- Lock-out tab on main breaker
- Mounting hardware and conduit fittings included
- 30A main breaker
- 12 cct panel
- 120/240 VAC 1 phase
- 10 kAIC rated
- Padlockable flip-up cover
- 1-in. top conduit entry and 1-in. pole access hole in back
- Contactors and controls section for up to two 4-pole contactors or flashers
- Listed on BC MOT&I recognized products list

Options

- Snowplow debris covers
- Up to 2 lighting contactors
- Flasher controls
- Sub-breakers as required up to 22 kAIC
- Additional contactors
- Crosswalk flasher
- Warning board flasher
- Up to 2 lighting contactors

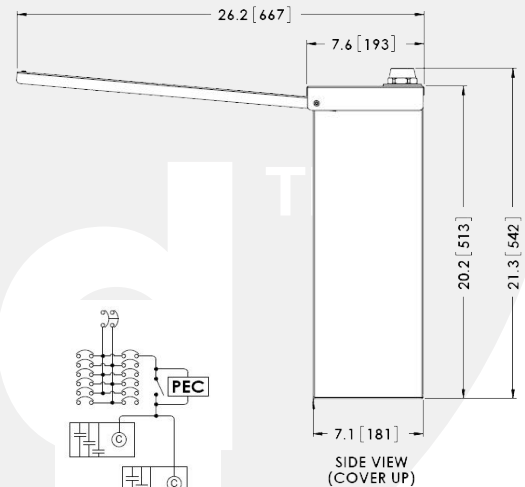
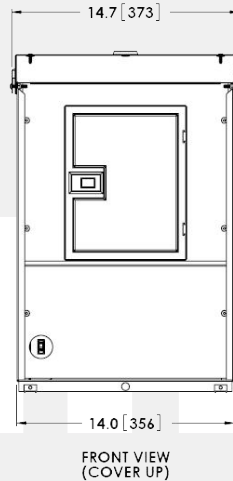
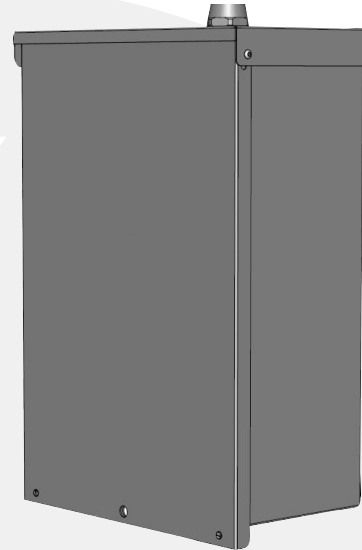

PART NUMBER	HEIGHT	WIDTH	DEPTH	MATERIAL	MAIN BREAKER
HWYSP8-3S	20 in	14 in	7.5 in	STAINLESS STEEL	30 A

Contact Valid for all available options.